



# DUAL POWER PAK

MODEL No 346, 346-IO-QR



Model: 346-IO-QR



## USER INSTRUCTIONS

EN DE DK ES FR IT NL NO PL SE

**CAUTION**

Provide ample ventilation. This gas appliance consumes air (oxygen). Do not use this appliance in an unventilated space to avoid endangering your life. If still more gas appliances and/or occupants using gas are added to the space, additional ventilation must be provided.

**IMPORTANT**

Read these instructions carefully so as to familiarise yourself with the appliance before fitting the appliance to a gas cylinder.  
Retain these instructions for future reference.

## 1. General

- The purpose of this appliance is to be a light weight, compact power source for CADAC camping products when the user does not want to use a large LPG cylinder. The user simply connects two gas cartridges to the Dual Power Pak and then to a GrilloGas / Skottel / Carri Chef 50, or another compatible unit.
- This regulator complies with EN16129:2013
- Appliance category: I3B(28-30mbar) All EU, NO, IS, CH, TR, DE, AT and LU
- Appliance category: I3B(50mbar) DE, AT and LU
- Only to be used with EN417 type disposable cartridges (CADAC CA445,CA500).
- The gas cartridge is to be used only in the upright position.
- Gas appliances require ventilation for efficient performance and to ensure the safety of users and other persons in close proximity.
- The Power Pak is fitted with a regulator with a maximum supply rate of 1.0kg/hour.
- The user may adjust the supply rate of the Power Pak unit by turning the control valve on the Power Pak from fully closed to fully open.

Country name abbreviations			
AT=Austria	DK=Denmark	GB=UnitedKingdom	NO=Norway
BE=Belgium	ES=Spain	IE=Ireland	PL=Poland
CH=Switzerland	FI=Finland	IT=Italy	PT=Portugal
DE=Germany	FR=France	NL=Netherlands	SE=Sweden
SI=Slovenia			

## 2. Safety information

- The Power Pak is guaranteed for a period of 2 years against factory faults. Natural wear and tear and valve components. Plastic parts are excluded. The same applies to damage caused by improper handling, misuse or repair by an unauthorized LP gas dealer. Liability is limited to replacement to the replacement of products. Never use in an unventilated room with all windows and doors closed.
- Never place the Power Pak on a stove, and always keep it at least 1 meter away from any source of heat, and ensure it is not placed in an environment where the temperature will exceed 50°C.
- Always store, transport or use the Power Pak in an upright position.
- When not in use, keep the valve closed, even if it is empty.
- Check that the seals (Fig. 1) are in place and in good condition before connecting the gas container to the appliance. Do not use the appliance if it has a damaged or worn seal. If in doubt, replace the seal before use.
- Do not use an appliance which is leaking, damaged or which does not operate properly (malfunctioning).
- If you suspect a gas leak, soapy water must be applied to the joints (the appliance must not be fully immersed in soapy water as this may result in an unsafe operation of the appliance). Any leakage will be seen as bubbles coming from the leakage point. If you cannot remedy any leakage, unscrew the gas cartridge from the appliance and return the appliance to your stockist.
- The appliance should only be used in a well-ventilated location (minimum ventilation requirement 5m<sup>3</sup>/h) in order to satisfy official ventilation standards for the supply of sufficient combustion air and to avoid the dangerous building up of unburned gases.
- Gas cartridges must be fitted or changed in a well-ventilated location, preferably outside and away from any sources of ignition, such as naked flames, pilots, electric fires and away from other people.
- Never leave the appliance unattended when in use.
- Do not modify the appliance. Do not use it for anything for which it has not been designed.
- In normal conditions of use, in order to ensure the correct operation of the Power Pak, it is recommended that this regulator is changed within 10 years of the date of manufacture.
- Do not move the Power Pak during operation.
- Do not use the Power Pak in small enclosed spaces without ventilation.

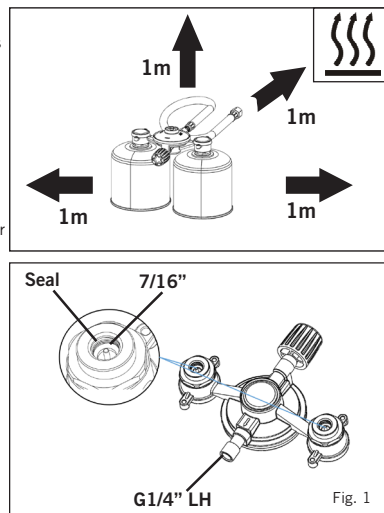

Fig. 1

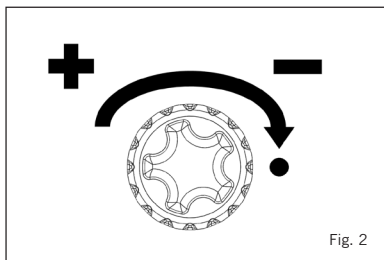

Fig. 2

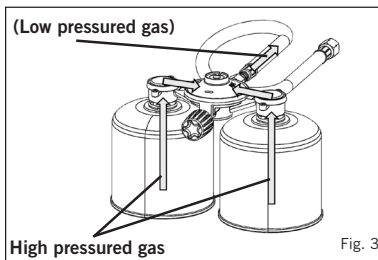

Fig. 3

### 3. Operation of the Power Pak

- Before operating the appliance, ensure all seals are in good condition. If you are unsure, replace the seals.
- Ensure that the hose is connected securely to the valve outlet of the Power Pak.
- Connect the other end of the hose securely to the appliance you wish to operate.
- First ensure the control knob on the appliance you are going to operate is in the "off" position.
- Insert the two gas cartridges onto the unit by screwing them in place (Fig. 4).
- Turn the control knob on the Power Pak anti-clockwise to increase the gas flow (Fig. 2).
- Then turn on the appliance you wish to operate, and light the appliance.
- Adjust the control knob, to reach the desired level gas flow to the appliance.
- Heat control to be done using the appliance control knob.

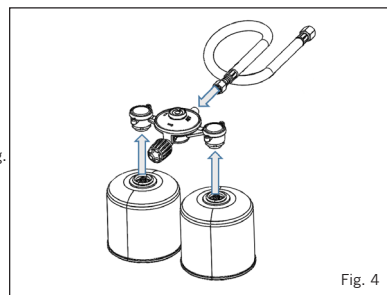

Fig. 4

### 4. To disassemble the unit

- Close the control knob.
- Remove the cartridge by unscrewing it.
- Disconnect the hose from the appliance and pack the unit away for storage.
- Cartridges should always be stored in a cool, dry, well-ventilated area.

### 5. Checking for leaks (Gas cartridge)

- To check the gas cartridge for leaks, apply soapy water to the connection area of the gas cartridge and see if any bubbles are visible. Any leakage will be seen as bubbles coming from the leakage point. If you cannot remedy any leakage, return the cartridge to your stockist.

### 6. Assembly

#### 346

- 1: Hand wheel (17mm Hex) and hose component
- 2: Move the handle wheel to the end of the hose sliding it over the brass nut.
- 3: Connect brass nut to the inlet of the BBQ, turn the hand wheel to tighten.

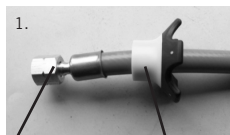

Brass nut Hand Wheel

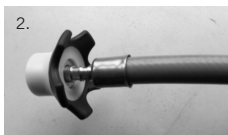

#### 346-QR

- 1: Remove QR male.
- 2: Connect QR male to the inlet of your product and turn to tighten.
- 3: Connect QR female to QR male by pushing the QR female onto the QR male.



QR Male QR Female





LIVE THE BRAAI LIFE

#### **CADAC SA**

P.O. Box 43196,  
Industria, 2042 South Africa  
Tel: +27 11 470 6600  
Email: info@cadac.co.za  
www.cadacinternational.com

#### **CADAC UK**

14 Deanfield Court,  
Link59 Business Park,  
Clitheroe, Lancashire,  
BB7 1QS  
United Kingdom.  
Tel: +44 (0) 333 2000363  
E-mail: info@cadacuk.com  
www.cadacinternational.com

#### **CADAC MOZAMBIQUE**

Exclusive Brands Africa  
492 Avenida Namaacha  
Maputo, Mozambique  
Tel: +258 21 406254  
www.cadac.co.mz

#### **CADAC IRAN**

Robin Bazarganan Carin Co.  
Unit D, 6th Floor, Negin Zafar  
Building, No.1327,  
Shariati Street, Tehran, Iran  
Tel: +98 21 276 00 781  
Mail: info@cadac.ir

#### **CADAC CHINA**

Room 807, Huayue International  
Building, No.255 Tiangao Road,  
South  
Yinzhou business district,  
Ningbo, China  
Tel: +86 574 87723937  
Email: info@cadac.com.cn

#### **CADAC SWEDEN & NORWAY**

KAMA FRITID AB  
0046 36 353700  
info@kamafritid.se

#### **CADAC EUROPE**

Ratio 26, 6921 RW Duiven  
The Netherlands  
Tel: +31 26 319 7740  
Email: info@cadaceurope.com  
www.cadacinternational.com

#### **CADAC SCANDINAVIA**

Millarco International A/S  
Rokhøj 26  
8520 Lystrup, Denmark  
Phone: +45 87 43 42 00  
millarco@millarco.dk  
www.millarco.com

#### **CADAC MONTENEGRO**

City kvart Z1L6  
81000 Podgorica, Montenegro  
Tel 38220671446,  
38269020063  
E-mail: coca@t-com.me

#### **CADAC DENMARK**

Camper Fritid  
Industrivej 11  
6640 Lunderskov, Denmark  
Tel.: +45 7558 5255  
Email: info@camper.dk  
www.camper.dk

#### **CADAC ZIMBABWE**

Exclusive Brands Africa  
Unit 8 Birkenhead Park  
43 Josiah Chinamano Street  
Belmont, Bulawayo  
Tel: +263 971 740 (Bul)  
Tel: +263 479 2564 (Har)  
www.cadac.co.zw

#### **CADAC GERMANY**

Ratio 26, 6921 RW Duiven  
The Netherlands  
Tel: +31 26 319 7740  
Email: info@cadaceurope.com  
www.cadacinternational.com

#### **CADAC Czech Rep.**

RÖSLER Praha spol. s r.o.  
K Horkám 19/21  
102 00 Praha 10 Česká republika  
Tel: +420 267 188 011  
Email: info@rosler.cz  
www.rosler.cz

#### **CADAC FINLAND**

OY KAMA FRITID AB  
Koivuhaantie 2-4 B  
01510 VANTAA  
00358 20 792 0310  
info@kamafritid.fi

#### **CADAC POLAND**

Kamai  
Wola Batorska 461  
32-007 Wola Batorska Poland  
Tel: +48 12 635 1373  
Email: handlowy@kamai.pl  
www.kamai.pl

#### **CADAC ZAMBIA**

Exclusive Brands Africa Limited  
7225A Kachidza Road  
Light Industrial Area  
Lusaka, Zambia  
Tel: +260 211 842015  
Tel: +260977 345034  
Email: info@ebagrp.com

#### **CADAC FRANCE**

Le Viallon, 42520 Veranne  
France  
Tel: +33 4 74 78 13 65  
Email: info@cadaceurope.com  
www.cadacinternational.com

#### **CADAC NEW ZEALAND**

Riverlea Group (Pty) Ltd  
2A Maui Street, Pukete,  
Hamilton 3200, New Zealand  
Tel: +64 7 847 0204  
Email: sales@riverleagroup.co.nz  
www.riverleagroup.co.nz

#### **CADAC U.A.E.**

Supreme Impex General Trading  
LLC Office No. 1801-7 Latifa  
Tower Sheikh Zayed Road  
Dubai, UAE

#### **CADAC ITALY**

Brunner SRL/GMBH  
via Buozzi, 8  
39100 Bolzano (Italy)  
Tel: +39 0471 542900  
Email: info@brunner.it  
www.brunnerinternational.com

#### **CADAC SOUTH EAST EUROPE**

Bulevar oslobođenja 285  
Tel: +381 11 339 2700  
Email: sinisaj@cadac.rs  
www.cadac.rs